

## Welded Top Flange

## Specialty Options

- Weld sizes and lengths shown on chart.
- Weld-on applications produce maximum allowable load listed. **Uplift loads do not apply to this application.**
- All welding should be done in accordance with the American Welding Society (AWS) Standard by a certified welder.  
**Caution: Welding galvanized steel may produce harmful fumes and should only be performed in well-ventilated environments.**

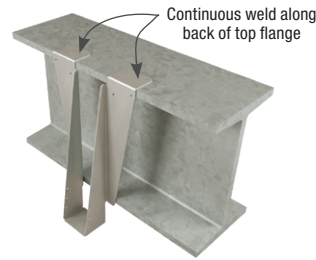

Typical top flange welded installation

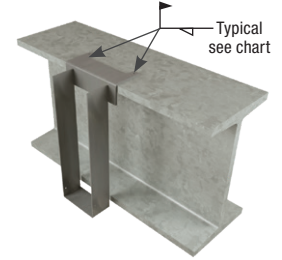

Typical top angle welded installation

### Top Angle Weld Length Chart

| MiTek USP Welded Hanger Series                        | Weld Length |
|---|-------------|
| SW  | 3"          |
| BPH, FWH, HBPH, PHM, SWH                              | 4"          |
| FWHBP, FWHFM, FWHH, KLB, KHW, PHXU                    | 6"          |
| KB, KGB, KHGB, KHHB, KGLS, KGLST, KGLT, KHGLS, KHGLST | 8"          |
| HLBH, KHGLT   | 10"         |

| Top Angle Steel Gauge | Weld Size |
|-----------------------|-----------|
| 14 - 10 gauge         | 1/8"      |
| 7 gauge               | 3/16"     |
| 3 gauge               | 1/4"      |

Weld shall be distributed evenly.

## Part Number System

Part Numbers assigned to TFL, THO, IHFL, IHF, THFI and THF I-Joist hangers reveal the I-Joist sizes to be used with the specific hanger. This guide will teach you how to recognize I-Joist dimensions in the part numbers.

1st, 3rd, and sometimes 4th digits are whole numbers  
 (This example denotes 2 and 11)  
 4th digit may be part of a decimal –



2nd and 5th digits are decimals  
 (see guide below)  
 (This example denotes .3125  
 [5/16] and .875 [7/8])  
 5th digit may be (0) or dropped if height is even

### Part Number Guide for Decimals

|               |    |           |
|---------------|----|-----------|
| 1 = .125      | or | 1/8 inch  |
| 2 or 25 = .25 | or | 1/4 inch  |
| 3 = .3125     | or | 5/16 inch |
| 5 = .5        | or | 1/2 inch  |
| 6 = .625      | or | 5/8 inch  |
| 7 = .75       | or | 3/4 inch  |
| 8 = .875      | or | 7/8 inch  |

# THO35925-2

## THO

Letters refer to Hanger Series  
 ex.: THO

## 35

First (2) Digits refer to Member Width  
 ex.: 3.5 inches

## 925

Last (2) or (3) Digits refer to Member Height  
 ex.: 9.25 inches

## -2

Digits after Dash refer to Number of Plies  
 ex.: 2-ply

### Some Examples:

THO15950 ..... 1-1/2" x 9-1/2"

IHFL17925..... 1-3/4" x 9-1/4"

THO16925-2 ..... double 1-5/8" x 9-1/4"

THF23925-2..... double 2-5/16" x 9-1/4"

**Note:** MiTek's USP Product Catalog lists a range of heights for IHFL/IHF hangers. Face mount hangers can usually accommodate more than one I-Joist height. The hanger height must be tall enough to support the top chord of the I-Joist to eliminate web stiffener requirements for lateral stability. The IHFL/IHF hanger must be a minimum of 60% of the joist height.